

A library is so much more than a collection of books. It's a place where minds expand and imaginations blossom. Where we can gain resources, engage with others, and learn something new. A place where communities come to meet and grow.

***When communities build libraries,
libraries build communities.***

Our goal to raise \$2.5 million for the construction of a new library in Ogallala is off to a great start. Thanks to generous contributions from local individuals, businesses, and civic organizations, the former elementary school at West 7th and B Streets has been demolished, and the site is ready for construction of the new library.

With your help, we can make the dream of a new library in Ogallala a reality.

**THE OGALLALA NEW LIBRARY PROJECT
IS A COLLABORATIVE EFFORT OF:**

City of Ogallala
Keith County, Nebraska
Goodall City Library Trustees
Keith County Foundation Fund
and the Ogallala Library Building Account
Friends of the Library

PLEASE CONTACT US WITH ANY QUESTIONS:

Kendra Caskey, Library Director
308.284.4354

Mike Tuttle, Trustees Board President
308.280.0323



**HELP US BUILD
OGALLALA'S
NEW LIBRARY
& LEARNING CENTER**



The Ogallala Library Building Account is an account of the Keith County Foundation Fund, an affiliated fund of Nebraska Community Foundation, a 501(c)(3) organization.

A welcoming space where all ages may gather to be enriched, enlightened, informed and connected.

Why Do We Need a New Library?

The Goodall City Library has served Ogallala well since 1954, but in recent years, a number of serious concerns have emerged:

ACCESSIBILITY

Patrons must go up or down steps to access either level. The elevator is outdated with an inadequate weight limit. All doors and bathrooms are not compliant with ADA (Americans With Disabilities Act) standards. Parking is street only without curb ramps.

LIMITED SPACE

There is no community meeting space in the current library, which limits programming opportunities. The computer lab is crowded. The Youth Library downstairs has limited shelf space and inadequate play areas for infants and toddlers. The two-level building creates staffing inefficiencies.

INFRASTRUCTURE

The Youth Library lacks central air-conditioning and must use inefficient window units. The concrete floor downstairs is unstable. The boiler system is archaic and costly to repair and maintain. Improper drainage on the flat roof causes water leakage. Technology requirements have outpaced the building's electrical capabilities. The lobby is not temperature controlled or ventilated. There are plumbing issues as well as odors and musty smells throughout the building.

Not only will a new library provide the necessary physical upgrades, it will allow for expanded programming opportunities for all ages. We are building a library and learning center for the 21st century. Priorities include:

- Community meeting space
- Expanded children's area
- Genealogy center
- Makerspaces

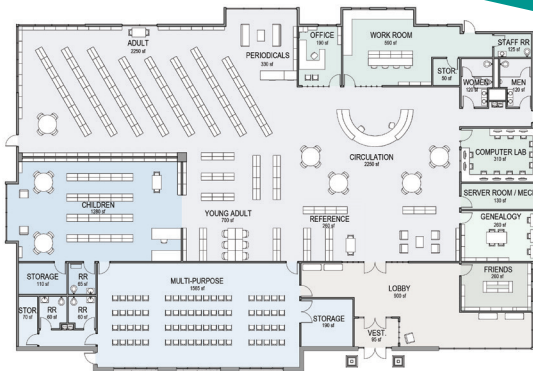

Rendering of new library floor plan

Ogallala Library Project Giving Levels

PATRON | \$100–\$249

FRIEND | \$250–\$499

PARTNER | \$500–\$999

SPONSOR | \$1,000–\$4,999

SILVER BENEFACTOR | \$5,000–\$9,999

GOLD BENEFACTOR | \$10,000–\$24,999

PLATINUM BENEFACTOR | \$25,000 and up

Contact Kendra Caskey at 308.284.4354 for more information about library and room naming opportunities.

Support

I would like to support the Ogallala Library Project in the following way:

ONE CONTRIBUTION in full: \$ _____

ANNUALLY: \$ _____

QUARTERLY: \$ _____ per quarter for _____ quarters beginning _____.

MONTHLY by ACH withdrawal from my bank account: \$ _____ per month for _____ months beginning _____.
Please attach completed Donor ACH Authorization form.

I would like to fulfill my pledge with:

- Cash Marketable securities Ag commodities
 Other _____
Please specify

Donor Name(s) _____
Please print

Address _____

City _____ State _____ ZIP _____

Phone _____

Email _____

Signature _____

Date _____

Please detach this form and send to:

Keith County Foundation Fund
ATTN: Ogallala Library Project
P.O. Box 104
Ogallala, NE 69153

Or donate online:

www.nebcommfound.org/give/keith-county-foundation-fund

